

Link do produktu: <https://higienadent.com/premium-plus-koncowka-do-skalera-e1e2-emswoodpecker-1szt-p-3296.html>



Premium Plus końcówka do skalera E1/E2 EMS/Woodpecker 1szt.

Cena	59,99 zł
Dostępność	Dostępny
Numer katalogowy	A
Producent	Premium Plus

Opis produktu

Premium Plus końcówka do skalera E1/E2 EMS/Woodpecker.

Dwa rodzaje do wyboru:

1. Uchwyt pilnika endo 120° do płukania przedniego kanału korzeniowego.
2. Uchwyt pilnika endo 95° do płukania kanałów zębów trzonowych.

Opakowanie: końcówka do skalera 1szt w wybranym wariantcie.

E1 (ED1/ES1)

120° file holder used to hold the file diameter $\Phi 0.7\text{mm}$ or $\Phi 0.8\text{mm}$. Recommended for irrigating of root canal, usually used for anterior teeth.

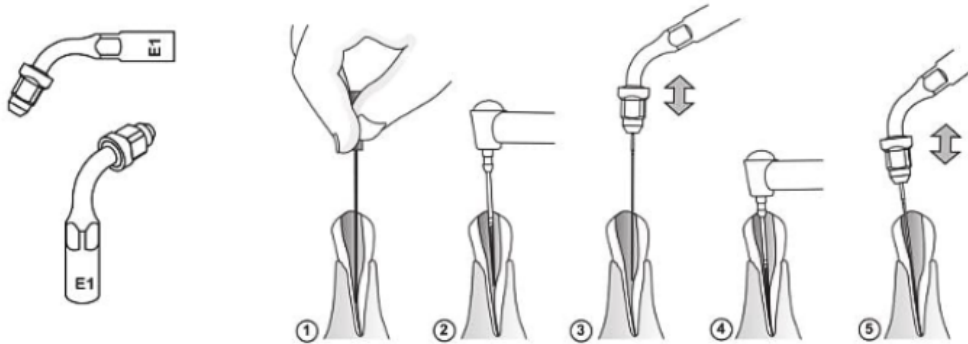

Use only the provided wrench (TW-E/TW-A) to tighten the file holder to handpiece, as well as tighten the file to the file holder. Make sure not over tighten it, and don't tighten the holder nut without file in the hold. Don't mix-install $\Phi 0.7\text{mm}$ and $\Phi 0.8\text{mm}$ file on the file holder, the $\Phi 0.8\text{mm}$ file will not be able to be installed after a $\Phi 0.7\text{mm}$ installed.

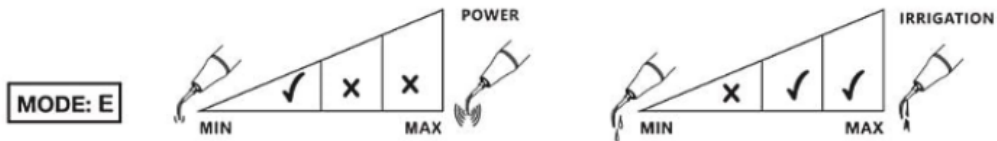

E2(ED2/ES2)

95° file holder used to hold the file diameter $\Phi 0.7\text{mm}$ or $\Phi 0.8\text{mm}$. Recommended for irrigating of root canal, usually used for molar teeth.

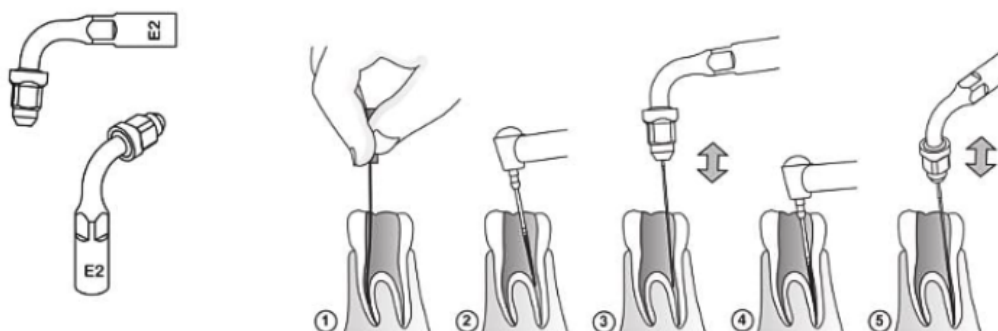

Use only the provided wrench (TW-E/TW-A) to tighten the file holder to handpiece, as well as tighten the file to the file holder. Make sure not over tighten it, and don't tighten the holder nut without file in the hold. Don't mix-install $\Phi 0.7\text{mm}$ and $\Phi 0.8\text{mm}$ file on the file holder, the $\Phi 0.8\text{mm}$ file will not be able to be installed after a $\Phi 0.7\text{mm}$ installed.

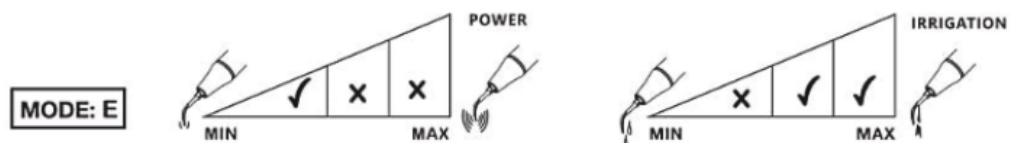

Produkt posiada dodatkowe opcje:

Rodzaj: E1 EMS/Woodpecker , E2 EMS/Woodpecker